

2024 GOT TO BE NC FESTIVAL

GOT TO BE NC EXHIBITING MEMBERS

| GOT TO BE NC EXHIBITING MEMBERS | BOOTH # |
|--|---------|
| 1Eatz | 51 |
| A.L.L. Seasoning | 91 |
| Agri Supply | 26-27 |
| America's Best Nut Co | 76-77 |
| Appalachian Growers | 39 |
| Asheville Tea Company | 64 |
| Berry Best Jams | 88 |
| Bertie County Peanuts | 66 |
| Billy Bubs BBQ Sauces & Dry Rubs | 28 |
| Bob's Smokin Southern BBQ LLC | 40-41 |
| Bull City Pepper Co | 53 |
| Butterfields Candy | 52 |
| Carolina Gold | 62 |
| Carolina Packers Inc. | 42-43 |
| Carolina Pickle Company, Inc. | 44-45 |
| Coddle Creek Farms | 17-18 |
| Country Squire Winery | 11-12 |
| Crumble Cups - LLC | 105-106 |
| CW Dressings | 107 |
| Daddy Bob's Barbeque | 65 |
| Drink-A-Bull Winery | 89 |
| Duplin Winery | 22 |
| Ella's Popcorn | 86 |
| ENC Local Honey | 70 |
| End of Days Distillery | 15-16 |
| Faith and Freedom Foods | 71 |
| Floury Apron LLC | 8 |
| For the Love of Margaritas | 93 |
| FranCee Farms | 54-55 |
| Fuquay Spice and Tea | 59-60 |
| G&G Gourmet, Inc. | 57 |
| Gammie's Jams & more | 56 |
| GrahamsGoodsLLC | 34-36 |
| H. B. Thompson Farms, Inc. | 63 |
| Hinnant Family Vineyards | 98-99 |
| Homespun By Betty LLC | 61 |
| House of Hibiscus Teas | 80 |
| Jabba's Creations LLC | 68 |
| James Creek Cider House | 25 |
| Jammin Jays Dip | 30-31 |
| JOY Filled Foods | 46-47 |
| Killer Toffee | 9 |
| Le Bleu | 33 |
| Mama June's Magic Relish | 50 |
| MawMaw's Chicken Pies | 19 |
| Mayo Mills | 90 |
| McMasters' Hawg Sauce | 81 |
| Misty Morning Ranch | 49 |
| Nancy Jo's Homemade | 29 |
| NC Sheep Producers Association | 74-75 |
| NCDA&CS - Got to Be NC Store | 1-3 |
| NCDA&CS - NC Wine Info Booth | 6 |
| NCDA&CS - Visit NC Farms: Agritourism | 7 |
| North Carolina fudge | 4-5 |
| Now That's Fudge | 82 |
| Old Rudera Farm | 79 |
| Our State Magazine | 24 |
| Parker's Barbecue of Greenville, Inc. | 85 |
| PrepperEats | 32 |
| Puzzle Pop Popcorn | 73 |
| Raleigh Popsicle Co | 97 |
| Retro Meadery | 20 |
| Rick's Romeo Sauce | 72 |
| Rock of Ages Winery | 108-109 |
| Romesburg Family Farm | 38 |
| Root Flavors | 92 |
| Rusty's, Inc. DBA Rusty's Peanut Brittle | 87 |
| San Giuseppe Salami Company | 67 |
| Sarge's LLC | 37 |

ENTRANCE

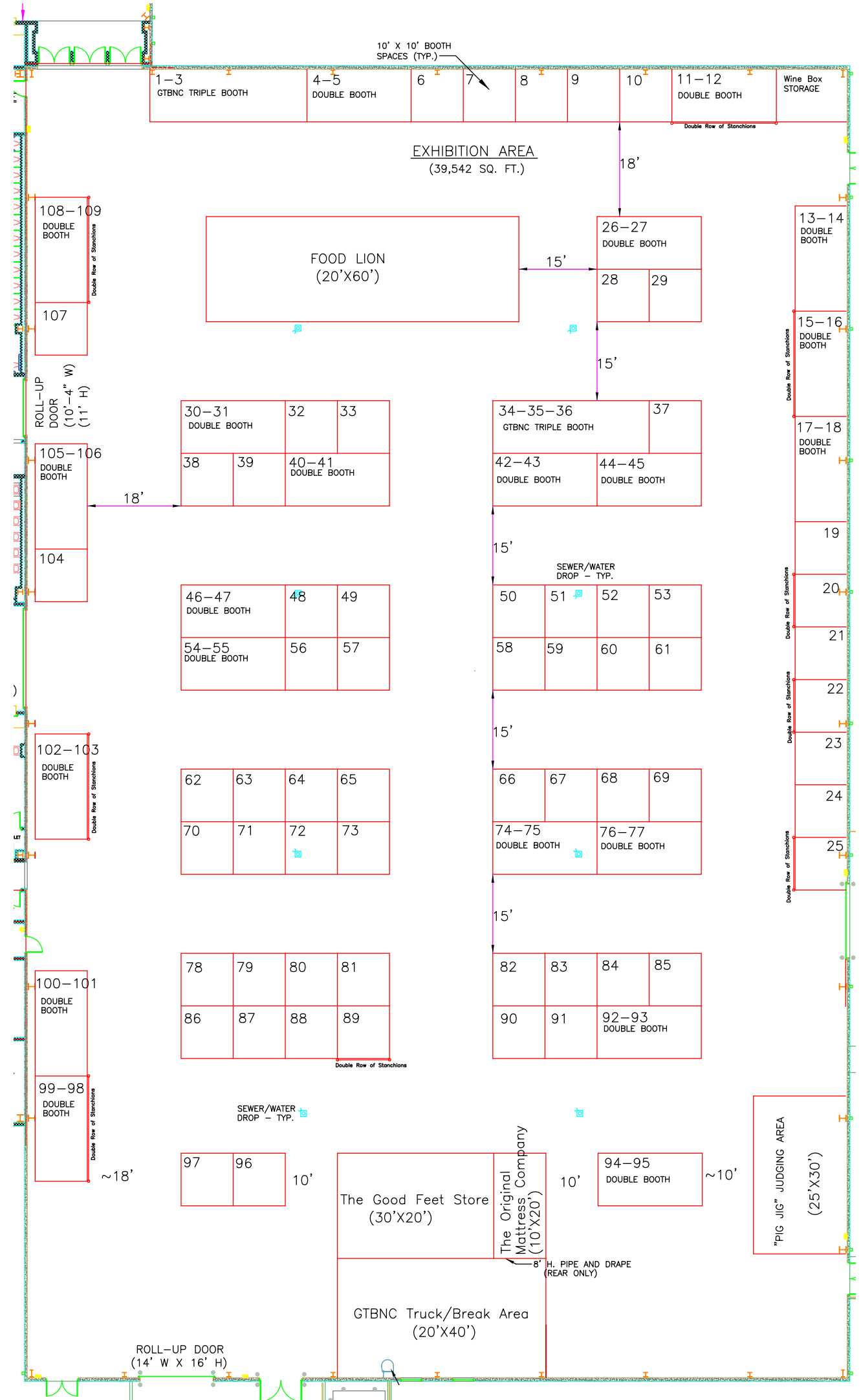

GOT TO BE NC EXHIBITING MEMBERS

| GOT TO BE NC EXHIBITING MEMBERS | BOOTH # |
|---------------------------------|---------|
| Shipwrecked Seasonings | 104 |
| Sisters II and Me Ice Cream | 58 |
| Sleepy Bee Worx, LLC | 69 |
| Slick's BBQ Sauce | 21 |
| Stephens Vineyard & Winery | 102-103 |
| Sweater Box Confections | 48 |
| Sweet Vine Products | 94-95 |
| Tar Heel Traveler | 96 |
| The Candy Coop at Frady Farms | 23 |
| Turbo's Sawdust LLC | 100-101 |
| Vegan Ice Cream Man | 84 |
| Wboy Food Group LLC. | 83 |
| Wilders | 13-14 |
| Woogie Foods | 10 |
| Zane's Carolina Seasoning | 78 |

Access this listing on your phone!

